

WHOLESALE ALUMINUM



SIGN - DOT - MARINE - ARCHITECTURAL - FENCE & RAILING - TRUCK & TRAILER
FOOD PROCESSING - HURRICANE PROTECTION - BLEACHERS - A/C STAND - CASTING - HARDWARE

📍 Miramar, FL
15701 SW 29th St, Suite 100
33027

📍 Deerfield Beach, FL
554 Hillsboro Technology Dr, Bldg. F
33441

📍 Boynton Beach, FL
3050 SW 14th Pl
33426

☎ (877) 959-0908
✉ sales@amdaluminum.com

🌐 www.amdaluminum.com

TABLE OF CONTENTS

ANGLE	4
CHANNEL	5
BAR	6
SQUARE TUBE	8
RECTANGULAR TUBE	9
PAINTED TUBES	10
ROUND TUBE AND PIPE	11
DOT TUBES AND FABRICATED PARTS	13
RAILING TOP CAP & BRACKETS	14
MECHANICAL FENCE	15
BLEACHER MATERIAL	16
AIR CONDITIONER STAND MATERIAL	16
SHEET, CHANNEL LETTER & TEES	17
N.A.S.A. INFORMATION	19
SUPERNOVA ACCORDION SHUTTER	20
BAHAMA SHUTTER	24
STORM PANELS	25

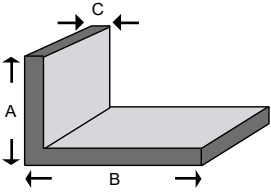

**ARCHITECTURAL ANGLE
UNEQUAL LEGS**
6063-T52 - 20' LENGTH

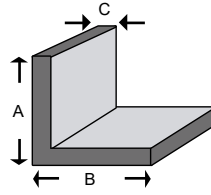

**ARCHITECTURAL ANGLE
EQUAL LEGS**
6063-T52 - 20' LENGTH

PART #	A	B	C	WT. LIN. FT	STATUS
7105120	1/2	1	1/8	0.206	MILL ORDER
7101112	1	1 1/2	1/8	0.356	IN STOCK
7107020	1	2	1/8	0.431	IN STOCK
7101320	1	3	1/8	0.582	MILL ORDER
7115020	1 1/2	2	1/8	0.506	IN STOCK
7103125	2	3	1/8	0.750	IN STOCK
7104125	2	4	1/8	0.881	IN STOCK
7102504	2	4	1/4	1.725	MILL ORDER
7105125	2	5	1/8	1.031	MILL ORDER
7107250	2	7	1/4	2.624	MILL ORDER

PART #	A	B	C	WT. LIN. FT	STATUS
7100020	1/2	1/2	1/16	0.069	IN STOCK
7101020	3/4	3/4	1/16	0.107	IN STOCK
7102020	3/4	3/4	1/8	0.206	IN STOCK
7103020	1	1	1/16	0.144	IN STOCK
7106020	1	1	1/8	0.281	IN STOCK
7102520	1	1	1/4	0.514	MILL ORDER
7109020	1 1/4	1 1/4	1/8	0.356	IN STOCK
7103520	1 1/2	1 1/2	1/16	0.219	IN STOCK
7106520	1 1/2	1 1/2	1/8	0.431	IN STOCK
7104020	1 1/2	1 1/2	3/16	0.637	IN STOCK
7118020	2	2	1/16	0.293	IN STOCK
7120020	2	2	1/8	0.581	IN STOCK
7121020	2	2	3/16	0.859	IN STOCK
7105020	2	2	1/4	1.124	IN STOCK
7108443	3	3	1/8	0.881	IN STOCK
7107120	3	3	1/4	1.725	IN STOCK
7103120	3 1/2	3 1/2	1/8	1.031	IN STOCK

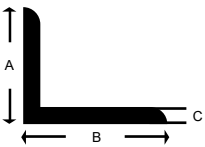

**STRUCTURAL ANGLE
EQUAL LEGS**
6061-T6511 - 25' LENGTH

PART #	A	B	C	WT. LIN. FT	STATUS
7101125	1	1	1/8	0.280	IN STOCK
7116125	1	1	3/16	0.408	MILL ORDER
7106125	1	1	1/4	0.514	IN STOCK
7111215	1 1/2	1 1/2	1/8	0.440	MILL ORDER
7115152	1 1/2	1 1/2	3/16	0.632	IN STOCK
7105524	1 1/2	1 1/2	1/4	0.830	IN STOCK
7102225	2	2	1/8	0.588	IN STOCK
7102025	2	2	3/16	0.870	IN STOCK
7105025	2	2	1/4	1.110	IN STOCK
7102125	2 1/2	2 1/2	3/16	1.070	IN STOCK
7102124	2 1/2	2 1/2	1/4	1.404	IN STOCK
7106025	3	3	3/16	1.310	IN STOCK
7107025	3	3	1/4	1.730	IN STOCK
7108025	3	3	3/8	2.474	IN STOCK
7108445	4	4	1/4	2.350	IN STOCK
7104438	4	4	3/8	3.366	IN STOCK
7104455	4	4	1/2	4.504	MILL ORDER
7106638	6	6	3/8	5.119	MILL ORDER
7106625	6	6	1/2	6.754	MILL ORDER

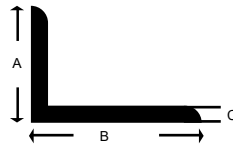

**STRUCTURAL ANGLE
UNEQUAL LEGS**
6061-T6511 - 25' LENGTH

PART #	A	B	C	WT. LIN. FT	STATUS
7102525	2	1 1/2	3/16	0.731	MILL ORDER
7109025	3	2	1/4	1.405	IN STOCK
7103224	3	2	3/16	1.090	MILL ORDER
7104314	4	3	1/4	1.988	IN STOCK
7103425	4	3	3/8	2.978	IN STOCK
7106425	6	4	3/8	4.237	MILL ORDER

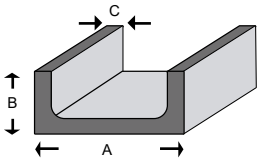

STRUCTURAL CHANNEL

6061-T6 - 25' LENGTH
ALUMINUM ASSOCIATION

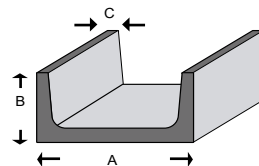

STRUCTURAL CHANNEL

6061-T6 - 25' LENGTH
AMERICAN STANDARD

PART #	A	B	C	D	WT. LIN. FT	STATUS
7213025	3.000	1.500	0.130	0.200	1.157	MILL ORDER
7204225	4.000	2.000	0.150	0.230	1.767	MILL ORDER
7224250	4.000	2.250	0.190	0.290	2.331	MILL ORDER
7206255	6.000	2.500	0.290	0.170	2.892	IN STOCK
7207225	7.000	2.750	0.290	0.170	3.27	IN STOCK

PART #	A	B	C	D	WT. LIN. FT	STATUS
7223025	3.000	1.400	0.170	0.170	1.482	IN STOCK
7224025	3.000	1.498	0.258	0.170	1.778	MILL ORDER
7203025	3.000	1.596	0.170	0.356	2.117	IN STOCK
7204025	4.000	1.580	0.180	0.180	1.833	IN STOCK
7225025	4.000	1.720	0.320	0.180	2.556	MILL ORDER
7205175	5.000	1.750	0.190	0.190	2.191	MILL ORDER
7225125	5.000	2.250	0.150	0.260	2.212	MILL ORDER
7226125	6.000	1.920	0.200	0.200	2.884	MILL ORDER
7272125	7.000	2.110	0.210	0.230	3.541	MILL ORDER
7208025	8.000	2.290	0.250	0.220	4.339	IN STOCK

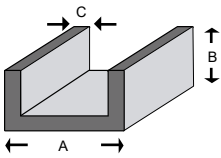

ARCHITECTURAL CHANNEL

6063-T52

PART #	A	B	C	LENGTH	WT. LIN. FT	STATUS
7201020	1/2	1/2	0.093	20'	0.148	MILL ORDER
7212420	1/2	3/4	1/8	24'	0.263	MILL ORDER
7203420	3/4	1/2	1/8	20'	0.226	MILL ORDER
7234020	3/4	3/4	1/8	20'	0.300	MILL ORDER
7209024	1	1	1/8	24'	0.431	IN STOCK
7216020	1 1/4	1 1/4	1/8	24'	0.526	IN STOCK
7213024	1 1/4	3/4	1/8	24'	0.376	IN STOCK
7212020	1 1/2	1	1/8	20'	0.487	IN STOCK
7221020	1 1/2	1 1/2	1/8	20'	0.637	IN STOCK
7210204	1 1/2	1/2	1/8	24'	0.337	MILL ORDER
7211020	1 1/2	3/4	1/8	20'	0.413	IN STOCK
7217020	1 3/4	3/4	1/8	20'	0.450	IN STOCK
7218024	2	1	0.093	24'	0.425	IN STOCK
7219024	2	1	1/8	24'	0.564	IN STOCK
7214020	2	1/2	1/8	20'	0.413	IN STOCK
7220024	2	2	1/8	24'	0.863	IN STOCK
7220020	3	1	1/8	20'	0.713	IN STOCK
7217026	CHANNEL COVER PLATE 2 X 16 FT 6063-T5 WORKS WITH 7220125 & 7221024					IN STOCK

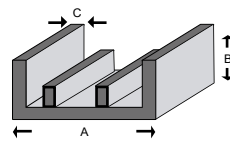

CHANNEL W/ LEGS

6063-T52 - 25' LENGTH

PART #	A	B	C	WT. LIN. FT	LEGS	STATUS
7211225	1 1/2	1	0.093	0.332	3/4	IN STOCK
7220125	2	1	0.093	0.395	1	IN STOCK
7221024	2	1	0.093	0.395	3/4	IN STOCK

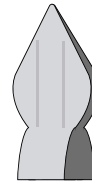

PRESSED SPEARS

CUSTOM SIZES AVAILABLE

PART #	A	B	C	LENGTH (IN.)	WT. LIN. FT	STATUS
7400047	3/4	3/4	0.062	58	0.206	IN STOCK
7400049	3/4	3/4	0.062	70	0.206	IN STOCK
7400051	1	1	0.062	58	0.278	IN STOCK
7400050	1	1	0.062	70	0.278	IN STOCK
7400055	1	1	0.062	82	0.278	IN STOCK

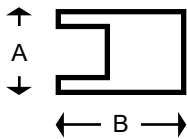

RECT FRAME FOR TONGUE & GROOVE

6063-T52 - 24' LENGTH

PART #	A	B	WT. LIN. FT
7902324	2	3	1.722

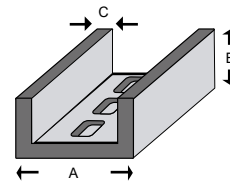

PUNCHED CHANNEL

6063-T52 - 24' LENGTH
STANDARD 3-3/4" SPACING

PART #	A	B	C	WT. LIN. FT	PUNCHED	STATUS
7218024-1	2	1	0.093	0.425	3/4	IN STOCK
7218024-2	2	1	0.093	0.425	1	IN STOCK
7219024-1	2	1	1/8	0.563	3/4	IN STOCK
7219024-2	2	1	1/8	0.563	1	IN STOCK

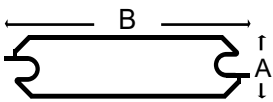

TONGUE & GROOVE

6063-T52 - 24' LENGTH

PART #	A	B	WT. LIN. FT
7900004	1	3.482	0.802
7900006	1	5.482	1.090



V TRACK

6063-T52 - 20' LENGTH

PART #	A	B	WT. LIN. FT
7722020	2.875	0.724	0.534



FLAT BAR

6063-T52 - 20' LENGTH



FLAT BAR

6061-T6511 12' LENGTH

PART #	A	B	WT. LIN. FT	STATUS
7801120	1/8	1/2	0.078	MILL ORDER
7812020	1/8	3/4	0.113	IN STOCK
7803020	1/8	1	0.152	IN STOCK
7831020	1/8	1 1/2	0.225	IN STOCK
7804020	1/8	2	0.300	IN STOCK
7805020	1/8	3	0.450	IN STOCK
7806020	1/8	4	0.600	IN STOCK
7801256	1/8	6	0.900	IN STOCK
7819020	3/16	1/2	0.113	MILL ORDER
7810020	3/16	5/8	0.141	MILL ORDER
7811020	3/16	3/4	0.169	MILL ORDER
7816020	3/16	1	0.226	IN STOCK
7813020	3/16	1 1/4	0.283	MILL ORDER
7814020	3/16	1 1/2	0.338	IN STOCK
7815020	3/16	2	0.451	IN STOCK
7821020	1/4	1/2	0.150	MILL ORDER
7820020	1/4	3/4	0.226	IN STOCK
7822020	1/4	1	0.300	IN STOCK
7823020	1/4	1 1/4	0.376	IN STOCK
7824020	1/4	1 1/2	0.450	IN STOCK
7825020	1/4	2	0.600	IN STOCK
7826020	1/4	3	0.900	IN STOCK
7827020	1/4	4	1.200	IN STOCK
7830020	1/4	6	1.800	IN STOCK
7834020	3/8	3/4	0.337	IN STOCK
7835020	3/8	1	0.450	IN STOCK
7837020	3/8	1 1/2	0.675	IN STOCK
7836020	3/8	1 3/4	0.563	MILL ORDER
7839020	3/8	2	0.900	IN STOCK
7841020	3/8	3	1.350	IN STOCK
7842020	1/2	1	0.600	IN STOCK
7845020	1/2	1 1/2	0.900	MILL ORDER
7843020	1/2	2	1.200	IN STOCK

PART #	A	B	WT. LIN. FT	STATUS
7801834	1/8	3/4	0.113	IN STOCK
7801812	1/8	1	0.150	IN STOCK
7818122	1/8	1 1/2	0.225	IN STOCK
7808212	1/8	2	0.300	IN STOCK
7808312	1/8	3	0.450	IN STOCK
7818412	1/8	4	0.600	IN STOCK
7816112	3/16	1	0.224	IN STOCK
7816121	3/16	1 1/2	0.338	IN STOCK
7816212	3/16	2	0.451	IN STOCK
7819003	3/16	3	0.677	MILL ORDER
7819042	3/16	4	0.898	IN STOCK
7841212	1/4	1/2	0.147	IN STOCK
7814342	1/4	3/4	0.221	IN STOCK
7822012	1/4	1	0.300	IN STOCK
7801412	1/4	1 1/4	0.376	IN STOCK
7811212	1/4	1 1/2	0.450	IN STOCK
7825012	1/4	2	0.600	IN STOCK
7825112	1/4	2 1/2	0.735	IN STOCK
7826012	1/4	3	0.900	IN STOCK
7827012	1/4	4	1.200	IN STOCK
7828012	1/4	5	1.500	IN STOCK
7830012	1/4	6	1.800	IN STOCK
7831012	1/4	8	2.352	IN STOCK
7814102	1/4	10	3.000	IN STOCK
7802512	1/4	12	3.600	IN STOCK
7835012	3/8	1	0.450	IN STOCK
7837112	3/8	1 1/2	0.675	IN STOCK
7839012	3/8	2	0.900	IN STOCK
7839112	3/8	2 1/2	1.126	IN STOCK
7841012	3/8	3	1.350	IN STOCK
7847012	3/8	4	1.800	IN STOCK
7843012	3/8	5	2.250	IN STOCK
7844012	3/8	6	2.700	IN STOCK
7846012	3/8	8	3.600	IN STOCK
78381012	3/8	10	4.410	MILL ORDER
7838122	3/8	12	5.400	IN STOCK
7832012	1/2	1	0.600	IN STOCK
7812112	1/2	1 1/2	0.900	IN STOCK
7829012	1/2	2	1.200	IN STOCK
7852512	1/2	2 1/2	1.500	IN STOCK
7834012	1/2	3	1.800	IN STOCK
7845012	1/2	4	2.400	IN STOCK
7836012	1/2	5	3.000	IN STOCK
7834112	1/2	6	3.600	IN STOCK
7812712	1/2	7	4.116	IN STOCK
7838012	1/2	8	4.800	IN STOCK
7838010	1/2	10	6.000	IN STOCK
7833012	1/2	12	7.056	MILL ORDER
7801214	1/2	14	8.470	MILL ORDER
7807512	3/4	1	0.881	MILL ORDER
7804112	3/4	1 1/2	1.350	MILL ORDER
7840012	3/4	2	1.800	MILL ORDER
7875512	3/4	2 1/2	2.205	MILL ORDER
7840312	3/4	3	2.700	IN STOCK
7803442	3/4	4	3.600	IN STOCK
7803410	3/4	10	8.812	MILL ORDER
7834121	3/4	12	10.800	IN STOCK

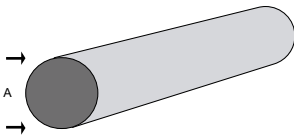

ROUND BAR

6061 T6511 - 12' LENGTH

PART #	A	WT. LIN. FT	STATUS
7800012	1/4	0.059	IN STOCK
7850012	1/2	0.235	IN STOCK
7802012	3/4	0.530	IN STOCK
7803812	3/8	0.133	IN STOCK
7813820	3/8	0.132	IN STOCK
7805812	5/8	0.368	IN STOCK
7807812	7/8	0.707	MILL ORDER
7801012	1	0.943	IN STOCK
7801142	1 1/4	1.472	MILL ORDER
7801212	1 1/2	2.110	IN STOCK
7801342	1 3/4	2.826	IN STOCK
7800212	2	3.770	MILL ORDER
7802142	2 1/4	4.676	MILL ORDER
7802121	2 1/2	5.891	IN STOCK
7802342	2 3/4	6.985	MILL ORDER
7803112	3	8.304	MILL ORDER
7831412	3 1/4	9.756	MILL ORDER
7831212	3 1/2	11.314	MILL ORDER
7804012	4	14.763	MILL ORDER
7804122	4 1/2	18.683	MILL ORDER
7805012	5	23.091	MILL ORDER
7806012	6	33.250	MILL ORDER
7807112	7	45.214	MILL ORDER
7808012	8	59.091	MILL ORDER

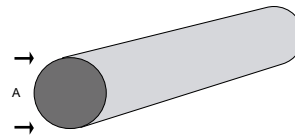

ROUND BAR

6063-T52 - 20' LENGTH

PART #	A	WT. LIN. FT	STATUS
7800020	1/4	0.060	IN STOCK
7801020	1/2	0.235	IN STOCK
7800120	5/8	0.368	MILL ORDER
7800030	1	0.942	IN STOCK
7802020	3/4	0.530	IN STOCK
7803820	3/8	0.133	IN STOCK

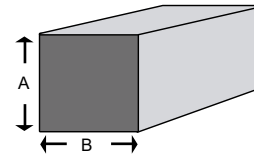

SQUARE BAR

6061-T6511 - 12' LENGTH

SKU	A&B	WT. LIN. FT	STATUS
7803752	3/8	0.169	IN STOCK
7872112	1/2	0.300	IN STOCK
7803412	3/4	0.675	IN STOCK
7811012	1	1.201	IN STOCK
7811412	1 1/4	1.888	MILL ORDER
7850144	1 1/2	2.745	IN STOCK
7801752	1 3/4	3.602	MILL ORDER
7802212	2	4.800	IN STOCK
7820512	2 1/2	7.350	MILL ORDER
7803312	3	10.584	MILL ORDER
7804412	4	18.797	MILL ORDER

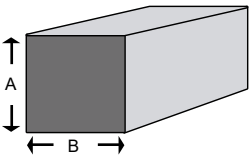

SQUARE BAR

6063-T52 - 20' LENGTH

SKU	A&B	WT. LIN. FT	STATUS
7872020	1/2	0.300	IN STOCK
7871020	3/8	0.169	IN STOCK
7873020	5/8	0.466	IN STOCK
7802520	3/4	0.674	IN STOCK
7807020	1	1.200	IN STOCK

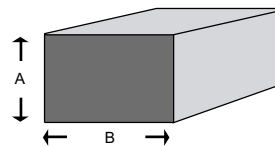

RECTANGULAR BAR

6061-T6511 - 12' LENGTH

PART #	A	B	WT. LIN. FT	STATUS
7801122	1	1 1/2	1.800	MILL ORDER
7810212	1	2	2.454	IN STOCK
7821212	1	2 1/2	2.940	MILL ORDER
7813012	1	3	3.528	IN STOCK
7814012	1	4	4.800	IN STOCK
7801612	1	6	7.200	MILL ORDER
7810244	1	10	11.760	MILL ORDER
7802114	1 1/4	2	2.940	MILL ORDER
7815021	1 1/2	2	3.600	IN STOCK
7801123	1 1/2	3	5.292	MILL ORDER
7811242	1 1/2	4	7.056	MILL ORDER
7811262	1 1/2	6	10.584	MILL ORDER
7802312	2	3	7.083	MILL ORDER
7802412	2	4	9.408	MILL ORDER
7802612	2	6	14.112	MILL ORDER

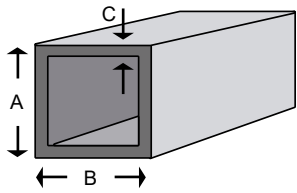

SQUARE TUBE

6063 T52 - 24' LENGTH

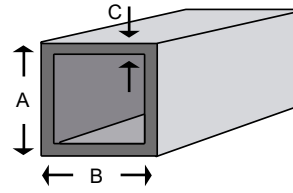

SQUARE TUBE

6061-T6 - 24' LENGTH

PART #	A & B	C	WT. LIN. FT	ALLOY	STATUS
7402024	1/2	0.065	0.136	6063-T52	IN STOCK
7403024	3/4	0.050	0.168	6063-T52	IN STOCK
7405024	3/4	0.062	0.206	6063-T52	IN STOCK
7407024	3/4	0.093	0.293	6063-T52	IN STOCK
7409024	3/4	1/8	0.374	6063-T52	IN STOCK
7405724	1	0.050	0.228	6063-T52	IN STOCK
7412024	1	0.062	0.278	6063-T52	IN STOCK
7414024	1	0.093	0.405	6063-T52	IN STOCK
7416024	1	1/8	0.524	6063-T52	IN STOCK
7420024	1 1/4	1/8	0.675	6063-T52	IN STOCK
7419024	1 1/2	0.093	0.632	6063-T52	IN STOCK
7423024	1 1/2	1/8	0.824	6063-T52	IN STOCK
7422024	1 3/4	0.093	0.740	6063-T52	IN STOCK
7424024	1 3/4	1/8	0.975	6063-T52	IN STOCK
7428024	2	0.062	0.604	6063-T52	IN STOCK
7429024	2	0.093	0.851	6063-T52	IN STOCK
7430024	2	1/8	1.126	6063-T52	IN STOCK
7432124	2	3/16	1.634	6063-T6	IN STOCK
7434024	2 1/2	0.082	0.916	6063-T52	IN STOCK
7401024	2 1/2	0.093	1.152	6063-T52	MILL ORDER
7431024	2 1/2	1/8	1.425	6063-T52	IN STOCK
7436024	3	0.093	1.298	6063-T52	IN STOCK
7437024	3	1/8	1.760	6063-T52	IN STOCK
7439024	3	1/4	3.300	6063-T6	IN STOCK
7441124	4	1/8	2.324	6063-T52	IN STOCK
7443124	4	1/4	4.500	6063-T52	MILL ORDER
7442024	5	1/8	2.925	6063-T52	IN STOCK
7405118	5	1/4	5.700	6063-T6	IN STOCK
7445024	6	1/8	3.525	6063-T52	IN STOCK
7406144	6	1/4	6.900	6063-T6	IN STOCK
7448024	8	3/16	7.050	6063-T52	MILL ORDER

PART #	A & B	C	WT. LIN. FT	LENGTH	STATUS
7403124	1 1/2	1/4	1.500	24	MILL ORDER
7429026	2	0.093	0.851	26	IN STOCK
7431124	2	1/8	1.126	24	IN STOCK
7432024	2	3/16	1.636	24	IN STOCK
7433024	2	1/4	2.100	24	IN STOCK
7441024	4	1/8	2.324	24	MILL ORDER
7443024	4	1/4	4.500	24	IN STOCK

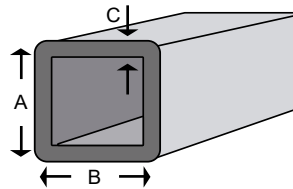

SQUARE TUBE W / RADIUS

6063-T52 & T6

PART #	A & B	C	RADIUS	WT. LIN. FT	LENGTH	ALLOY
7406224	3/4	0.040	0.093	0.131	24	6063-T52
7416224	3/4	0.062	0.090	0.204	24	6063-T52
7419324	3/4	0.093	0.090	0.293	24	6063-T52
7411024	1	0.062	1/8	0.268	24	6063-T52
7493124	1	0.093	1/8	0.389	24	6063-T52
7433224	2	1/4	0.250	2.052	24	6063-T6
7438025	3	3/16	0.313	2.502	25	6063-T6
7439025	3	1/4	0.313	3.204	25	6063-T6

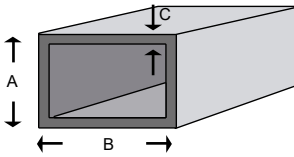

RECTANGULAR TUBE

6063-T52

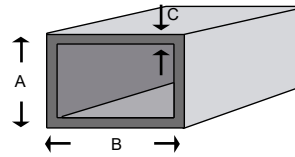

RECTANGULAR TUBE

6061-T6 - 24' LENGTH

PART #	A	B	C	WT. LIN. FT	LENGTH	STATUS
7501024	3/4	1 1/2	1/8	0.600	24	IN STOCK
7521024	1	1 1/2	1/8	0.676	24	IN STOCK
7506024	1	2	0.062	0.428	24	IN STOCK
7508024	1	2	0.093	0.628	24	IN STOCK
7509024	1	2	1/8	0.824	24	IN STOCK
7500624	1	3	0.062	0.558	24	IN STOCK
7510024	1	3	1/8	1.125	24	IN STOCK
7506224	1	4	0.062	0.725	24	IN STOCK
7511024	1	4	1/8	1.425	24	IN STOCK
7503024	1	5	1/8	1.726	24	IN STOCK
7501624	1	6	0.090	1.474	20	IN STOCK
7501620	1	6	1/8	2.026	24	IN STOCK
7506324	1 1/4	2 1/2	1/8	1.050	24	MILL ORDER
7522024	1 1/2	2	1/8	0.976	24	IN STOCK
7523024	1 1/2	3	1/8	1.272	24	IN STOCK
7501344	1 3/4	4	1/8	1.650	24	IN STOCK
7505024	1/2	1	0.093	0.292	24	IN STOCK
7507024	1/2	1 1/2	0.062	0.279	24	IN STOCK
7523904	2	3	0.080	0.907	24	IN STOCK
7520024	2	3	1/8	1.426	24	IN STOCK
7525024	2	4	1/8	1.724	24	IN STOCK
7530024	2	5	1/8	2.025	24	IN STOCK
7533024	2	6	1/8	2.327	24	IN STOCK
7534124	2	8	1/8	2.925	24	IN STOCK
7502104	2	10	1/8	3.541	24	IN STOCK
7503424	3	4	1/8	2.026	24	IN STOCK
7503624	3	6	1/8	2.625	24	IN STOCK
7503636	3	6	3/16	3.891	24	MILL ORDER
7503104	3	10	1/8	3.824	24	MILL ORDER
7504624	4	6	1/8	2.925	24	MILL ORDER
7540024	4	8	1/4	6.900	24	IN STOCK

PART #	A	B	C	WT. LIN. FT	STATUS
7502112	2	2 1/2	1/8	1.275	MILL ORDER
7524024	2	3	1/4	2.700	IN STOCK
7527024	2	4	1/4	3.300	IN STOCK
7531024	2	5	1/4	3.900	MILL ORDER
7533124	2	6	1/4	4.500	IN STOCK
7534024	2	8	1/8	2.962	MILL ORDER
7534224	2	8	1/4	5.700	IN STOCK
7535024	4	6	1/4	5.700	IN STOCK

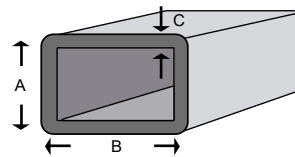

RECTANGULAR TUBE W / RADIUS

6063-T52 - 24' LENGTH

PART #	A	B	C	WT. LIN. FT	STATUS
7521824	1	2	1/8	0.809	IN STOCK

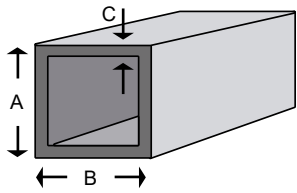

PAINTED SQUARE TUBE

6063 T52

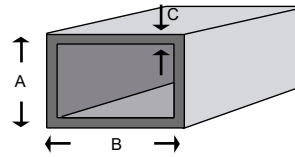

PAINTED RECTANGULAR TUBE

6063-T52 - LENGTH 24'

PART #	A&B	C	WT. LIN. FT	LENGTH (FT)	COLOUR	STATUS
1101072	2	0.093	0.851	6	WHITE	IN STOCK
1102072	2	0.093	0.851	6	BRONZE	IN STOCK
1103072	2	0.093	0.851	6	BLACK	IN STOCK
1101096	2	0.093	0.851	8	WHITE	IN STOCK
1102096	2	0.093	0.851	8	BRONZE	IN STOCK
1103096	2	0.093	0.851	8	BLACK	IN STOCK
1101288	2	0.093	0.851	24	WHITE	IN STOCK
1102288	2	0.093	0.851	24	BRONZE	IN STOCK
1103288	2	0.093	0.851	24	BLACK	IN STOCK
7413024	2	1/8	1.126	24	WHITE	IN STOCK
7440324	2	1/8	1.126	24	BRONZE	IN STOCK
7410934	3	0.093	1.298	24	WHITE	IN STOCK
7413924	3	0.093	1.298	24	BLACK	IN STOCK
7440924	3	0.093	1.298	24	BRONZE	IN STOCK
1111072	3	1/8	1.760	6	WHITE	IN STOCK
1112072	3	1/8	1.760	6	BRONZE	IN STOCK
1113072	3	1/8	1.760	6	BLACK	IN STOCK
1111096	3	1/8	1.760	8	WHITE	IN STOCK
1112096	3	1/8	1.760	8	BRONZE	IN STOCK
1113096	3	1/8	1.760	8	BLACK	IN STOCK
1111288	3	1/8	1.760	24	WHITE	IN STOCK
1112288	3	1/8	1.760	24	BRONZE	IN STOCK
1113288	3	1/8	1.760	24	BLACK	IN STOCK
1141072	4	1/8	2.324	6	WHITE	IN STOCK
1142072	4	1/8	2.324	6	BRONZE	IN STOCK
1143072	4	1/8	2.324	6	BLACK	IN STOCK
1141096	4	1/8	2.324	8	WHITE	IN STOCK
1142096	4	1/8	2.324	8	BRONZE	IN STOCK
1143096	4	1/8	2.324	8	BLACK	IN STOCK
1141288	4	1/8	2.324	24	WHITE	IN STOCK
1142288	4	1/8	2.324	24	BRONZE	IN STOCK
1143288	4	1/8	2.324	24	BLACK	IN STOCK

PART #	A	B	C	WT. LIN. FT	COLOUR	STATUS
1091288	1	2	0.093	0.628	WHITE	IN STOCK
1092288	1	2	0.093	0.628	BRONZE	IN STOCK
1093288	1	2	0.093	0.628	BLACK	IN STOCK
7511224	1	2	1/8	0.824	WHITE	IN STOCK
7541224	1	2	1/8	0.824	BRONZE	IN STOCK
7511124	1	3	1/8	1.125	WHITE	IN STOCK
7521124	2	3	1/8	1.426	WHITE	IN STOCK
7541124	2	3	1/8	1.426	BRONZE	IN STOCK
7511424	1	4	1/8	1.425	WHITE	IN STOCK
7541424	1	4	1/8	1.425	BRONZE	IN STOCK
7514224	2	4	1/8	1.724	WHITE	IN STOCK
7544224	2	4	1/8	1.726	BRONZE	IN STOCK
7512524	2	5	1/8	2.025	WHITE	IN STOCK
7542524	2	5	1/8	2.025	BRONZE	IN STOCK
7512624	2	6	1/8	2.327	WHITE	IN STOCK
7542624	2	6	1/8	2.327	BRONZE	IN STOCK

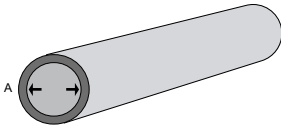

SCH 10 PIPE

6061-T6

PART #	A	OD	ID	WALL	WT. LIN. FT	LENGTH	STATUS
7310114	1 1/4	1.660	1.442	0.109	0.625	20	IN STOCK
7310112	1 1/2	1.900	1.682	0.109	0.721	20	IN STOCK
7310220	2 1/2	2.875	2.635	0.120	1.498	20	IN STOCK
7310212	2 1/2	2.875	2.635	0.120	1.498	24	IN STOCK

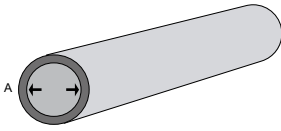

SCH 40 PIPE

6063-T52

PART #	A	OD	ID	WALL	WT. LIN. FT	LENGTH	STATUS
7301420	1/4	0.540	0.364	0.083	0.147	20	MILL ORDER
7338020	3/8	0.675	0.493	0.091	0.196	20	IN STOCK
7313020	1/2	0.840	0.622	0.109	0.300	20	IN STOCK
7314020	3/4	1.050	0.824	0.113	0.391	20	IN STOCK
7301820	1	1.315	1.049	0.133	0.581	20	IN STOCK
7318024	1	1.315	1.049	0.133	0.581	24	IN STOCK
7315120	1 1/4	1.660	1.380	0.140	0.803	20	IN STOCK
7315024	1 1/4	1.660	1.380	0.140	0.803	24	IN STOCK
7319120	1 1/2	1.900	1.610	0.145	0.940	20	IN STOCK
7319024	1 1/2	1.900	1.610	0.145	0.940	24	IN STOCK
7323020	2	2.375	2.067	0.154	1.264	20	IN STOCK

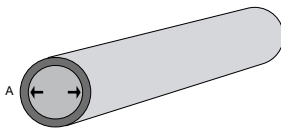

SCH 40 PIPE

6061-T6

PART #	A	OD	ID	WALL	WT. LIN. FT	LENGTH	STATUS
7318020	1	1.315	1.049	0.133	0.581	20	IN STOCK
7308024	1	1.315	1.049	0.133	0.581	24	IN STOCK
7315020	1 1/4	1.660	1.380	0.140	0.803	20	IN STOCK
7305124	1 1/4	1.660	1.380	0.140	0.803	24	IN STOCK
7319020	1 1/2	1.900	1.610	0.145	0.940	20	IN STOCK
7302320	2	2.375	2.067	0.154	1.264	20	IN STOCK
7324020	2 1/2	2.875	2.469	0.203	2.004	20	IN STOCK
7327020	3	3.500	3.068	0.216	2.621	20	IN STOCK
7328020	3 1/2	4.000	3.548	0.226	3.216	20	IN STOCK
7329020	4	4.500	4.026	0.237	3.733	20	IN STOCK
7300520	5	5.563	5.047	0.258	5.057	20	MILL ORDER
7331020	6	6.625	6.065	0.280	6.564	20	MILL ORDER

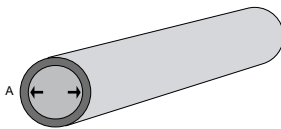

SCH 80 PIPE

6061-T6

PART #	A	OD	ID	WALL	WT. LIN. FT	LENGTH	STATUS
7381220	1 1/4	1.660	1.278	0.191	1.057	20	IN STOCK
7381520	1 1/2	1.900	1.500	0.200	1.282	20	IN STOCK
7380220	2	2.375	1.939	0.218	1.772	20	IN STOCK
7382520	2 1/2	2.875	2.323	0.276	2.705	20	IN STOCK

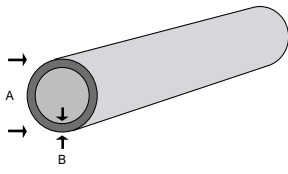

ROUND TUBE

6063-T52 24' LENGTH

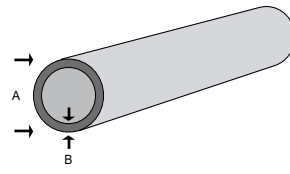

ROUND TUBE

6061-T6511 - 24' LENGTH

PART #	A	B	WT. LIN. FT	STATUS
7606524	3/4	0.065	0.172	IN STOCK
7601062	1	0.062	0.229	IN STOCK
7611024	1	1/8	0.412	IN STOCK
7610024	1 1/2	0.065	0.351	IN STOCK
7612024	1 1/2	1/8	0.648	IN STOCK
7618024	2	1/8	0.866	IN STOCK
7606184	6	1/8	2.713	MILL ORDER

PART #	A	B	WT. LIN. FT	STATUS
7609014	1 1/4	1/8	0.385	MILL ORDER
7618824	1 1/2	3/16	0.910	IN STOCK
7603424	1 3/4	1/8	0.750	MILL ORDER
7621824	2	1/8	0.866	IN STOCK
7614124	2	1/4	1.650	MILL ORDER
7626024	3	1/8	1.355	IN STOCK
7627024	4	1/8	1.826	IN STOCK

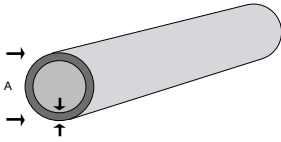

DOT ROUND TUBE

6061-T6

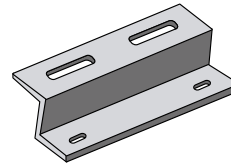

FABRICATED ZEE BAR

W / HOLES AND SLOTS 6061-T6

PART #	A	B	LENGTH	WT. LIN. FT	STATUS
7601DOT	2 1/2	1/8	12'6"	1.120	IN STOCK
7607DOT	2 1/2	1/8	15'	1.120	IN STOCK
7602DOT	3	1/8	13'6"	1.355	IN STOCK
7606DOT	3	1/8	15'	1.355	IN STOCK
7603DOT	3 1/2	3/16	15'	2.400	IN STOCK
7604DOT	3 1/2	3/16	17'	2.400	IN STOCK
7605DOT	3 1/2	3/16	20'	2.335	IN STOCK
7604016	4	1/4	16'	3.534	IN STOCK
7604017	4	1/4	17'	3.534	IN STOCK
7604020	4	1/4	20'	3.534	IN STOCK
7604520	4 1/2	1/4	20'	4.006	IN STOCK
7605020	5	1/4	20'	4.470	IN STOCK
7606015	6	1/4	15'	5.420	IN STOCK
7606016	6	1/4	16'	5.420	IN STOCK
7606020	6	1/4	20'	5.420	IN STOCK
7606024	6	1/4	24'	5.420	IN STOCK

PART #	A&B	C	LENGTH	WT. LIN. FT
7902DOT	1 3/4	3/16	8"	1.078
7914DOT	1 3/4	3/16	11"	1.078
7903DOT	1 3/4	3/16	14"	1.078
7904DOT	1 3/4	3/16	20"	1.078
7905DOT	1 3/4	3/16	26"	1.078
7906DOT	1 3/4	3/16	32"	1.078
7915DOT	1 3/4	3/16	38"	1.078
7907DOT	1 3/4	3/16	42"	1.078
7916DOT	1 3/4	3/16	46"	1.078
7908DOT	1 3/4	3/16	52"	1.078
7909DOT	1 3/4	3/16	56"	1.078

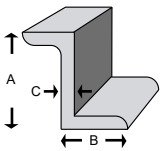

STRUCTURAL ZEE BAR

6061-T6

BOLT KITS

PART #	SIZE IN.	PICTURE
DOT-4-BOLT	4	
DOT-45-BOLT	4.5	
DOT-5-BOLT	5	
DOT-6-BOLT	6	

PART #	A	B	C	LENGTH	WT. LIN. FT
7910DOT	1 3/4	1 3/4	3/16	18'	1.109
7913DOT	1 3/4	1 3/4	3/16	25'	1.078
7917DOT	3	2 11/16	1/4	15'	1.109
7900DOT	3	2 11/16	1/4	18'	2.381
7911DOT	3	2 11/16	1/4	25'	2.381
7912DOT	3	2 11/16	1/4	30'	2.381
7901DOT	3	2 11/16	1/4	40'	2.381

BREAK AWAY (HALF)

PART #	SIZE IN.	PICTURE
DOT-4-BREAKAWAY	4	
DOT-45-BREAKAWAY	4.5	
DOT-5-BREAKAWAY	5	
DOT-6-BREAKAWAY	6	

U BOLTS WITH HARDWARE

PART #	SIZE IN.	PICTURE
8100025	2.5	
8100026	3	
8100027	3.5	
8100029	4	
8100030	4.5	
8100031	5	
8100032	6	







SOIL PLATE

6061-T6

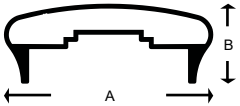
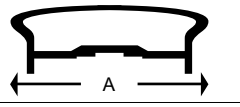
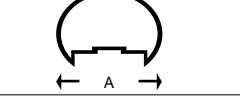
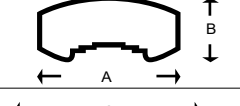
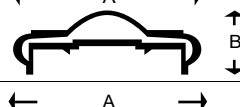
PART #	SIZE IN.	PICTURE
8100028	1/4 X 8 X 12 X 14 WITH SLOTS	
8100033	1/4 X 7 X 18 WITH SLOTS	

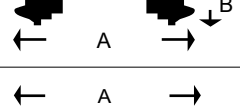
TOP CAP

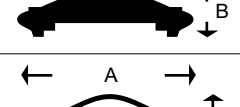
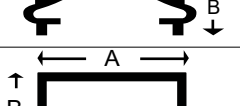
6063-T52

PART #	DESCRIPTION	A	B	WT. LIN. FT	LENGTH	PICTURE	STATUS
7701024	HOLLOW CAP	2 5/8	1	0.573	25'10"		IN STOCK
7703024	HOLLOW CAP	2 5/8	1 1/2	0.670	25'10"		IN STOCK
7704024	ROUND CAP	3		0.992	24'		IN STOCK
7704224	OVAL CAP	4	2	1.088	24'		IN STOCK
7706024	DIXIE CAP	2 5/8	1	0.558	24'		IN STOCK
7705024	DIXIE CAP	2 5/8	1 1/2	0.569	24'		IN STOCK
7709120	DIXIE CAP	2 1/4	7/8	0.668	20'		MILL ORDER
7708120	DIXIE CAP	1 3/4	9/16	0.516	20'		MILL ORDER
7709020	DIXIE CAP	2 1/4	7/8	1.180	20'		IN STOCK
7708020	DIXIE CAP	2 1/8	3/4	0.413	20'		MILL ORDER
7502124	FLAT CAP	2	1	0.921	24'		IN STOCK

PIPE BRACKET

6063-T52

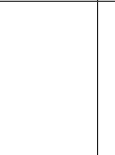
PART #	A	B	WT. LIN. FT	LENGTH	PICTURE	STATUS
7303412	3 1/8	4.409	2.160	12'		IN STOCK
7324016	2 1/4	3 7/8	2.036	16'		IN STOCK

MECHANICAL FENCE

HR13 3/4" PICKET			
	1081229	WHITE	19' 1"
	1082229	BRONZE	19' 1"
	1083229	BLACK	19' 1"
	1080229	MF	19' 1"
	1081276	WHITE	23'
	1082276	BRONZE	23'
	1083276	BLACK	23'
	1080276	MF	23'

HR5 - 1" PICKET			
	1041276	WHITE	23'
	1042276	BRONZE	23'
	1043276	BLACK	23'
	1040276	MF	23'

HR10 - TOP CAP 20'			
	1051240	WHITE	20'
	1052240	BRONZE	20'
	1053240	BLACK	20'
	1050240	MF	20'

HR4 - SNAP POST			
	1031234	WHITE	19' 6"
	1032234	BRONZE	19' 6"
	1033234	BLACK	19' 6"
	1030234	MF	19' 6"
	1031276	WHITE	23'
	1032276	BRONZE	23'
	1033276	BLACK	23'
	1030276	MF	23'

HR11A TOP SNAP			
	1061240	WHITE	20'
	1062240	BRONZE	20'
	1063240	BLACK	20'
	1060240	MF	20'

HR14 - TOP CAP			
	HR14-240-WH	WHITE	20'
	HR14-240-BZ	BRONZE	20'
	HR14-240-BLK	BLACK	20'

HR2 POST PLATE			
	1011234	WHITE	19' 6"
	1012234	BRONZE	19' 6"
	1013234	BLACK	19' 6"
	1010234	MF	19' 6"
	1011276	WHITE	23'
	1012276	BRONZE	23'
	1013276	BLACK	23'
1010276	MF	23'	

HR12 - BOTTOM CHANNEL			
	1071234	WHITE	19' 6"
	1072234	BRONZE	19' 6"
	1073234	BLACK	19' 6"

HR1 - TOP CAP			
	HR1-240-WH	WHITE	20'
	HR1-240-BZ	BRONZE	20'
	HR1-240-BLK	BLACK	20'

HR3 - BOTTOM CHANNEL			
	1021234	WHITE	19' 6"
	1022234	BRONZE	19' 6"
	1023234	BLACK	19' 6"
	1020234	MF	19' 6"

BLEACHER MATERIAL

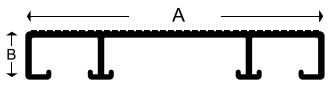

BLEACHER PLANK
6063-T6

PART #	A	B	WT. LIN. FT	LENGTH (FT)
7901019	10	1.75	2.553	19.5
7901021	10	1.75	2.553	21
7901024	10	1.75	2.553	24
7901025	10	1.75	2.553	25.5
7901027	10	1.75	2.553	27
7901030	10	1.75	2.553	30
7901230	12	1.75	3.139	30

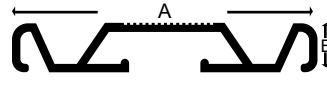

RISER BOARD
6063-T6

PART #	A	B	WT. LIN. FT	LENGTH (FT)
7900621	6	0.875	1.096	21
7900630	6	0.875	1.096	30

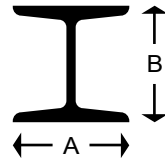

I-BEAM
6063-T6

PART #	A	B	LENGTH (FT)
7905525	5	5	6.488

AIR CONDITIONER STAND MATERIAL

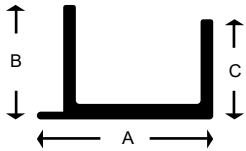

CHANNEL
6063-T6 - 20'3" LENGTH

PART #	A	B	C	WT. LIN. FT
7201175	1.752	1.125	1	0.752



LIGHT I-BEAM CLIP
6061-T6 - 12' LENGTH

PART #	A	B	WT. LIN. FT
7202512	2.004	0.565	0.753

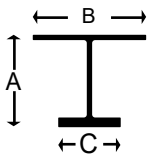

LIGHT I-BEAM
6061-T6

PART #	A	B	C	LENGTH (IN)	WT. LIN. FT
7225303	3	2.5	1.374	36	0.994
7225306	3	2.5	1.374	72	0.994
7225309	3	2.5	1.374	108	0.994
7225312	3	2.5	1.374	144	0.994
7225318	3	2.5	1.374	216	0.994

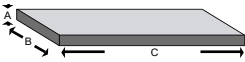

ALUMINUM SHEET 3003-H14

PART #	A	B	C	WT/SHEET APPROX.	STATUS
7903248	0.032	48	120	18.24	IN STOCK
7904080	0.040	48	96	18.24	IN STOCK
7904010	0.040	48	120	22.80	IN STOCK
7905008	0.050	48	96	22.81	MILL ORDER
7905010	0.050	48	120	28.52	IN STOCK
7906348	0.063	48	96	28.74	IN STOCK
7906312	0.063	48	120	35.92	IN STOCK
7908481	0.080	48	96	36.49	IN STOCK
7904808	0.080	48	120	45.60	IN STOCK
7909096	0.090	48	96	41.60	IN STOCK
7904912	0.090	48	120	51.60	IN STOCK
7948303	0.190	48	96	85.12	IN STOCK



ALUMINUM SHEET 5052-H32

PART #	A	B	C	WT/SHEET APPROX.	STATUS
7905012	0.050	48	144	34.21	IN STOCK
7904144	0.063	48	144	42.23	IN STOCK
7906144	0.063	60	144	52.80	IN STOCK
7908048	0.080	48	96	36.48	IN STOCK
7908052	0.080	48	120	45.60	IN STOCK
7908144	0.080	48	144	53.28	IN STOCK
7908510	0.080	60	120	55.50	IN STOCK
7980512	0.080	60	144	66.60	IN STOCK
7980612	0.080	72	144	79.92	MILL ORDER
7904012	0.090	48	144	60.48	IN STOCK
7909512	0.090	60	144	77.40	IN STOCK
7909612	0.090	72	144	90.15	MILL ORDER
7904812	0.125	48	96	56.00	IN STOCK
7900196	0.125	48	120	70.00	IN STOCK
7912512	0.125	48	144	84.00	IN STOCK
7900510	0.125	60	120	87.50	IN STOCK
7900512	0.125	60	144	105.00	IN STOCK
7900612	0.125	72	144	126.00	IN STOCK
7904719	0.190	48	96	85.12	IN STOCK
7948120	0.190	48	120	106.40	IN STOCK
7919012	0.190	48	144	127.58	IN STOCK
7936012	0.190	60	120	133.00	IN STOCK
7920012	0.190	60	144	159.24	IN STOCK
7925048	0.250	48	96	111.68	IN STOCK
7905820	0.250	48	120	144.00	IN STOCK
7944812	0.250	48	144	167.52	IN STOCK
7905104	0.250	60	120	174.50	IN STOCK
7960250	0.250	60	144	209.40	IN STOCK
7907212	0.250	72	144	251.28	MILL ORDER
7903758	0.375	48	96	169.00	IN STOCK
79054X8	0.500	48	96	223.36	IN STOCK
7905120	0.500	48	120	286.00	MILL ORDER

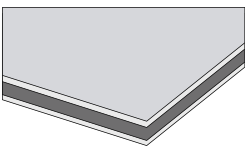

ALUMINUM COMPOSITE PANEL

PART #	A	B	C	COLOUR	STATUS
7900648	3MM/0.02 SKIN	48	96	WHITE / WHITE	IN STOCK
7900810	3MM/0.02 SKIN	48	120	WHITE / WHITE	IN STOCK
7900348	3MM/0.02 SKIN	48	96	MILL FINISH	MILL ORDER
7910608	6MM/0.02 SKIN	48	96	WHITE / WHITE	IN STOCK
7910610	6MM/0.02 SKIN	48	120	WHITE / WHITE	IN STOCK

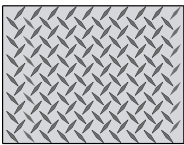

ALUMINUM TREAD BRITE SHEET 3003-H22/H24

PART #	A	B	C	WT/SHEET APPROX.	STATUS
7963412	0.063	48	144	49.75	MILL ORDER
7905063	0.063	48	96	33.31	IN STOCK
7906063	0.063	48	120	37.20	IN STOCK
7908148	0.080	48	96	40.50	MILL ORDER
7908112	0.080	48	144	61.30	MILL ORDER
7912548	0.125	48	96	61.46	IN STOCK
7910125	0.125	48	120	76.82	IN STOCK
7912125	0.125	48	144	92.19	MILL ORDER
7901510	0.125	60	120	96.03	IN STOCK
7905483	0.190	48	96	91.24	IN STOCK
7948250	0.250	48	96	118.40	IN STOCK
7925041	0.250	48	120	143.99	MILL ORDER



ALUMINUM PAINTED SHEET 3003-H14

PART #	A	B	C	WT / SHEET APPROX.	COLOUR	STATUS
7912441	0.024	48	120	14.08	WHT/WHT	MILL ORDER
7904850	0.032	48	96	14.60	WHT/WHT	IN STOCK
7913240	0.032	48	120	18.25	LOW GLOSS WHT/BRZ	IN STOCK
7915120	0.032	48	120	18.25	WHT/BRZ	MILL ORDER
7914120	0.032	48	120	18.25	WHT/WHT	IN STOCK
7914808	0.040	48	96	18.25	WHT/WHT	IN STOCK
7914812	0.040	48	120	23.40	WHT/WHT	IN STOCK
7918120	0.040	48	120	23.40	WHT/BLK	IN STOCK
7917120	0.040	48	120	23.40	WHT/BRZ	IN STOCK
7916120	0.040	48	120	23.40	WHT/RED	IN STOCK
7915010	0.050	48	120	28.51	WHT/WHT	IN STOCK
7922120	0.063	48	120	35.93	WHT/WHT	IN STOCK
7923096	0.080	48	96	36.48	WHT/WHT	IN STOCK
7923120	0.080	48	120	46.00	WHT/WHT	IN STOCK

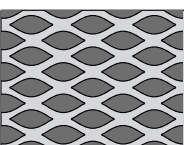

ALUMINUM EXPANDED METAL

PART #	HOLE	A	B	C	WT/SHEET APPROX.	STATUS
7906408	1/2	0.081	48	96	13.44	IN STOCK
7906409	3/4	0.125	48	96	19.84	IN STOCK

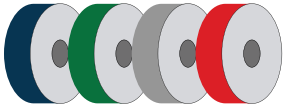

CHANNEL LETTER COIL

LENGTH 270'

PART #	THICKNESS	WIDTH	COLOR	STATUS
7963027	0.063	2	MILL FINISH	IN STOCK
7953277	0.063	3	MILL FINISH	IN STOCK
7935271	0.040	3.5	BLK/WHT	IN STOCK
7935270	0.040	3.5	WHT/WHT	IN STOCK
7943271	0.040	4.3	BLK/WHT	IN STOCK
7943272	0.040	4.3	BRZ/WHT	IN STOCK
7943273	0.040	4.3	SILVER	IN STOCK
7943270	0.040	4.3	WHT/WHT	IN STOCK
7953271	0.040	5.3	BLK/WHT	IN STOCK
7953272	0.040	5.3	BRZ/WHT	IN STOCK
7953276	0.040	5.3	CHEVRON BLUE	IN STOCK
7953274	0.040	5.3	HERON BLUE	IN STOCK
7953275	0.040	5.3	IVY GREEN	IN STOCK
7953273	0.040	5.3	RED/WHT	IN STOCK
7953270	0.040	5.3	WHT/WHT	IN STOCK

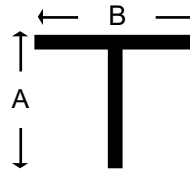

STRUCTURAL TEE BAR

6061-T51 LENGTH 25'

PART #	A	B	C	WT. LIN. FT	STATUS
7911316	1 1/2	1 1/2	3/16	0.700	IN STOCK
7902225	2	2	1/4	1.282	IN STOCK

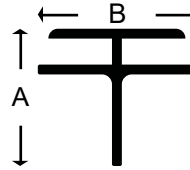

DOUBLE TEE DIVIDER

6063-T52 - LENGTH 24'

PART #	A	B	WT. LIN. FT	STATUS
7911224	1 1/2	1 1/2	0.585	IN STOCK
7921224	2 1/2	2 1/2	0.821	IN STOCK

N.A.S.A. INFORMATION

National Approved Shutter Association, LLC

Model, Number or Name	FL #
SUPERNOVA ACCORDION SHUTTER EXTRUDED ALUMINUM ACCORDION SHUTTER	16893-R4
REGENCY ALUMINUM ACCORDION SHUTTER LARGE MISSILE IMPACT RESISTANT ALUMINUM ACCORDION SHUTTER	16984-R2
60mm IMPACT RATED ROLLING DOOR IMPACT RESISTANCE ALUMINUM ROLLING DOOR	16996-R2
58mm ROLL-UP SHUTTER SYSTEM	17001-R2
RE 1000, RE 1500, SERIES 400 AND SERIES 600 EXTRUDED ALUMINUM ROLLING SHUTTER	17425-R2
RE 1500 ULTRA ER EXTRUDED ALUMINUM IMPACT PROTECTIVE SYSTEM	17426-R2
0.050" ALUMINUM STORM PANEL	17686-R1
IMPACT PROTECTIVE ROLLING SYSTEM W/CHD-6 SLAT NON-HVHZ	29820
ROLL UP SHUTTER SYSTEM W/CHD-6 SLAT HVHZ	29821

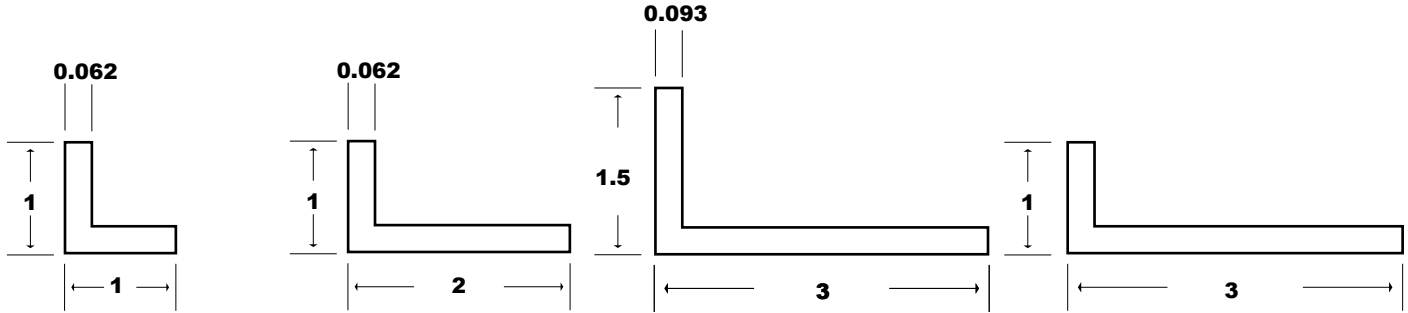

101 - 1"x 1" x .062 ANGLE

102 - 1"x 2" x .062 ANGLE

104 - 1½"x 3" x .093 ANGLE

112 - 1"x 3" x .125 ANGLE

111 - 1"x 3" x .062 ANGLE

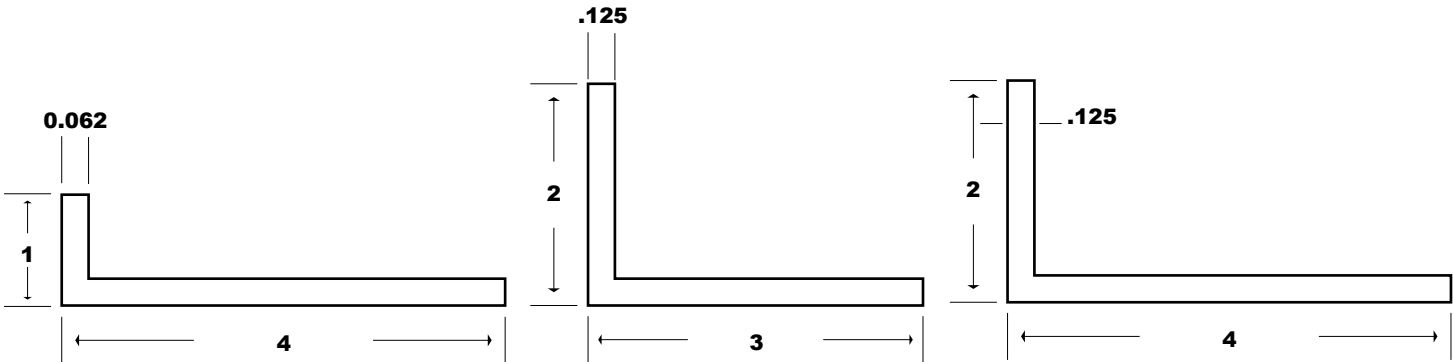

108 - 1"x 4" x .062 ANGLE

105 - 2"x 3" x .125 ANGLE

106 - 2"x 4" x .125 ANGLE

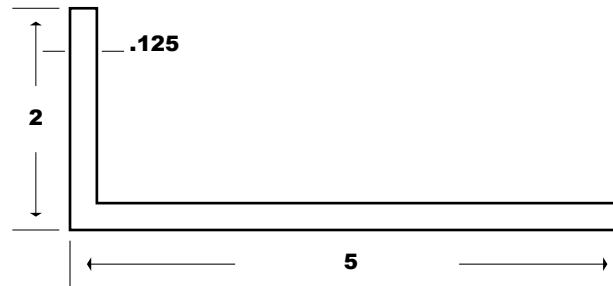

107 - 2"x 5" x .125 ANGLE

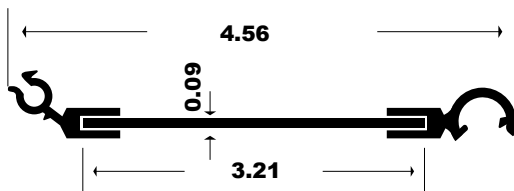

313 - CLEAR BLADE

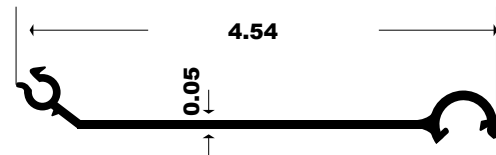

371 - BLADE



370 - UNIVERSAL C/M W/PIN

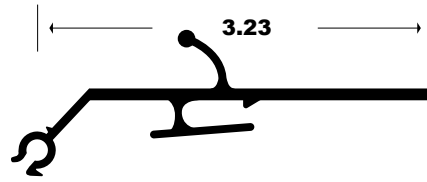

352 - UNIVERSAL C/M NO PIN

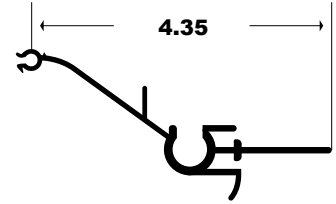

374 - UNIMATE

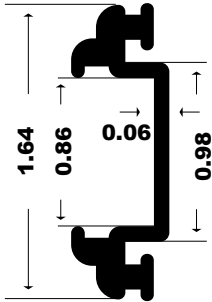

362 - COMMERCIAL INSERT

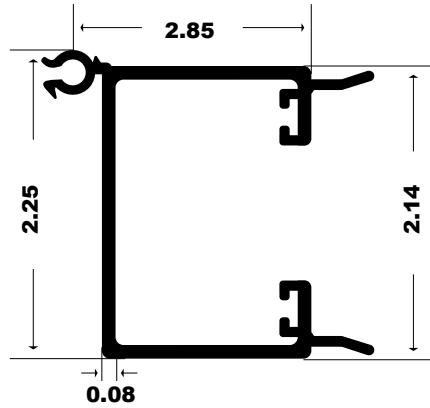

361 - COMMERCIAL C/M FEMALE

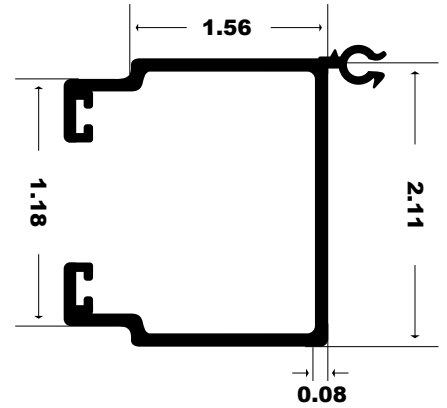

360 - COMMERCIAL C/M MALE

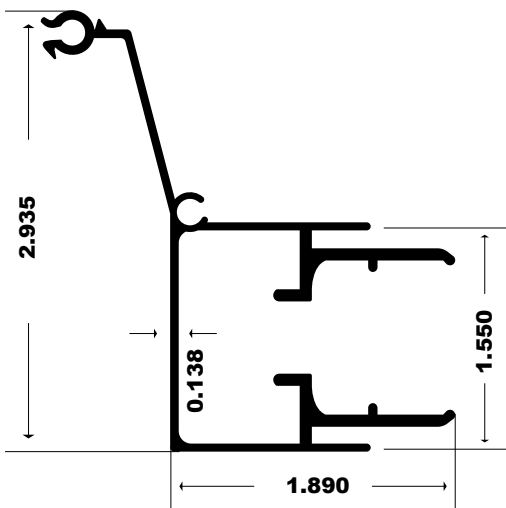

336 - HI TECH FEMALE CM

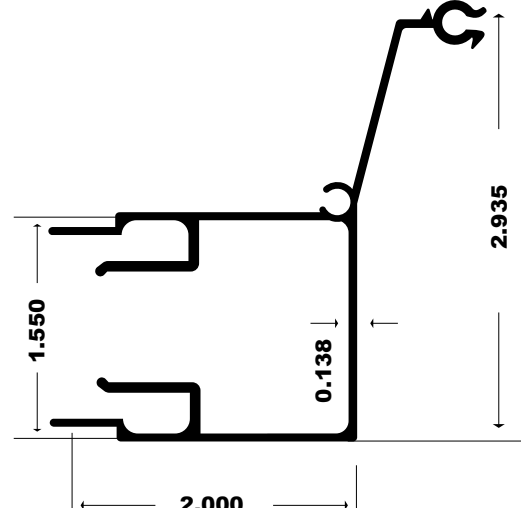

335 - HI TECH MALE CM

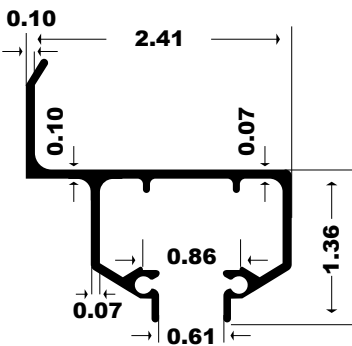

366 - 5/8" WALL HEADER

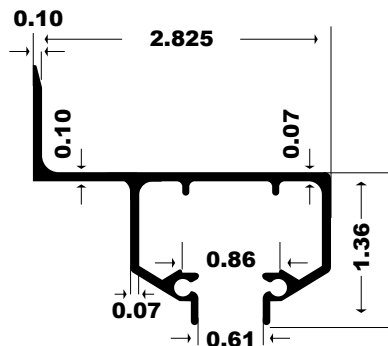

367 - 1" WALL HEADER

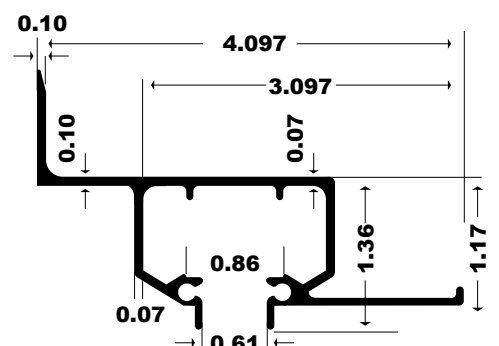

353 - 1" WALL HEADER RAINGUARD

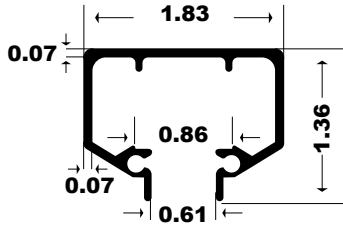

368 - CEILING HEADER

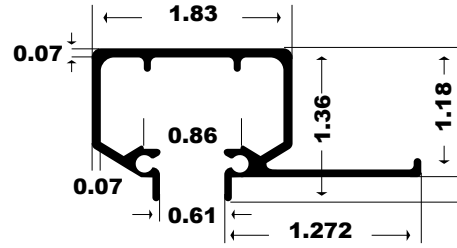

354 - CEILING HEADER RAINGUARD

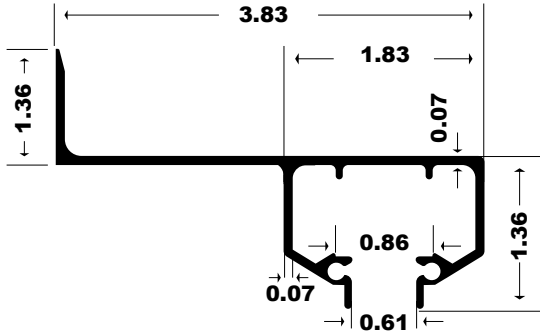

369 - 2" B/O WALL HEADER

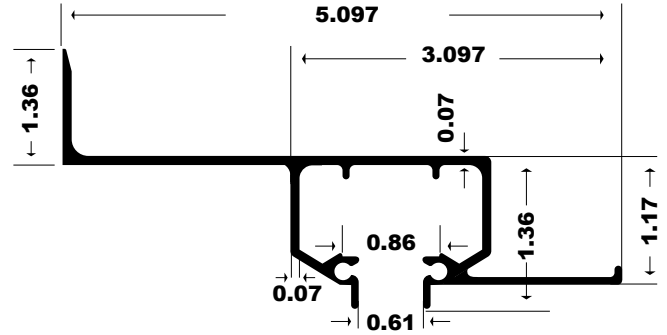

355 - 2" B/O WALL HEADER RAINGUARD

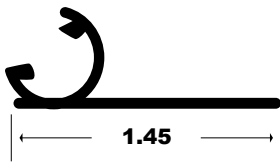

363 - STARTER



364 - DIRECT MOUNT 1"

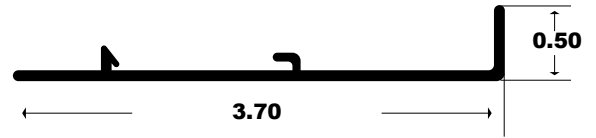

365 - DIRECT MOUNT 2"

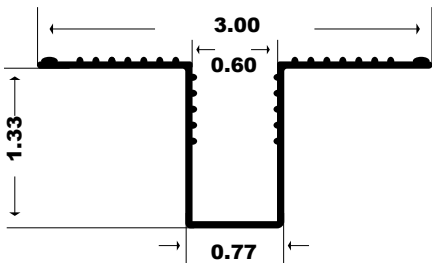

358 - RECESSED TRACK

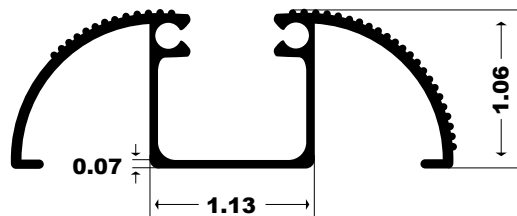

359 - WALKOVER

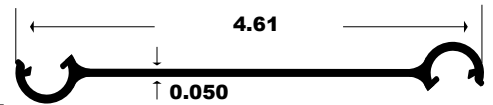

333 - FLOATING ADAPTER BLADE

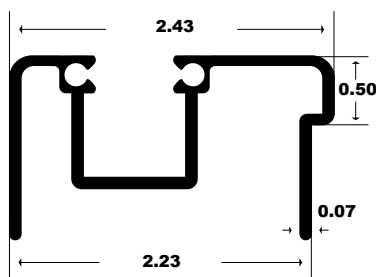

356 - ADJUSTABLE TOP

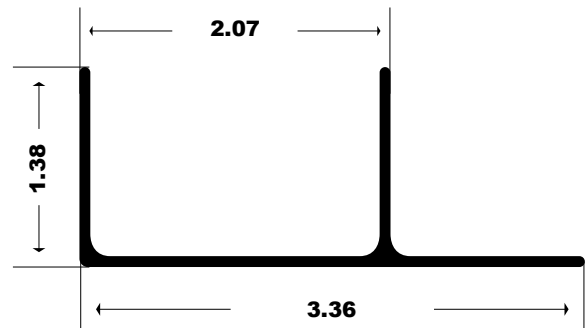

357 - ADJUSTABLE BOTTOM



9040110 - THUMB TURN LOCK



9041100 - PUSH BUTTON LOCK WHITE
9042100 - PUSH BUTTON LOCK IVORY
9045100 - PUSH BUTTON LOCK SILVER



9030100 - STAINLESS STEEL SCREW
FOR PUSH BUTTON LOCK



9030101 - #10 X 2 SHUTTER SCREW
W / WASHER



9020100 - 5/8" BUSHING KIT



9020200 - 7/8" BUSHING KIT



9010100 - WHEEL ASSEMBLY 5/8"
BUSHING KIT





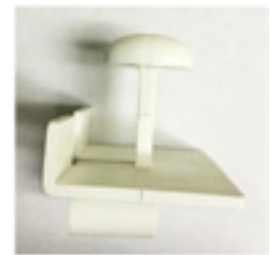



9046200 - HI TECH LOCK IVORY
9046500 - HI TECH LOCK BEIGE
9046600 - HI TECH LOCK SILVER

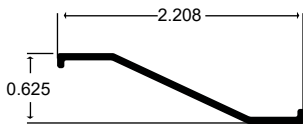

9061100 - SUPERNOVA PLASTIC
CLIP WHITE

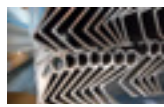
BAHAMA SHUTTERS

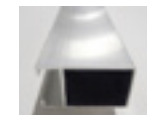
MILL FINISH 6063-T52 - 20' LENGTH

PART #	DESCRIPTION	WT. LIN. FT	PICTURE
4540240	LOUVER BLADE	0.166	
4550240	CENTER MULLION	0.407	
4570240	FEMALE HINGE	0.496	
4560240	MALE HINGE	0.169	
4530240	JAM	0.336	
4520240	TOP & BOTTOM	0.421	
	.063 X 7/8 COIL MILL FINISH 3003-H14		

LOUVER SHAPE

MILL FINISH 6063-T52 - 20' LENGTH

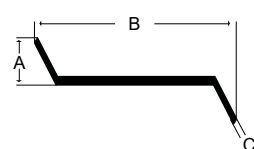
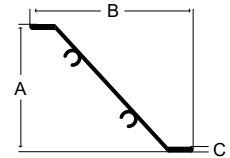
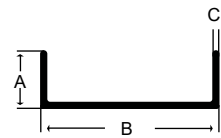
PART #	DESCRIPTION	A	B	C	PICTURE
7902620	LOUVER BLADE	0.431	2.654	0.087	
7927820	LOUVER BLADE W/ SCREW BOSSES	1.959	2.708	0.090	
7207520	CHANNEL	0.075	2.215	0.090	

ALUMINUM STORM PANELS

PART #	DESCRIPTION	COLOR	LENGTH	PICTURE
SP050ALUMCUSTOM	ALUMINUM STORM PANEL	MILL	CUSTOM	
SPCLEAR10	STORM PANEL	CLEAR	10'	
3231240	2" H-HEADER	WHITE	20'	
3221228	2" U-HEADER	WHITE	20'	
1F-TRACK	F-TRACK	WHITE	20'	
1091240	STUDDED ANGLE 2" X 2" X .093" 6" ON CENTER	WHITE	20'	

STORM PANEL

HARDWARE

PART #	DESCRIPTION	PICTURE
8150124	1/2" COMBO DRILL BIT	
8120140	1/4 - 20 MACHINE SCREW LEAD ANCHOR CTN 100	
8114075	1/4 X 3/4 SQUARE F TRACK BOLT SS CTN 100	
8114112	1/4-20 X 1-1/2 COMBO SIDEWALK BOLT 18-8 SS CTN OF 100	
8101420	1/4 - 20 WING NUTS WASHER CTN 100	



 (877) 959-0908
 sales@amdaluminum.com

 www.amdaluminum.com